

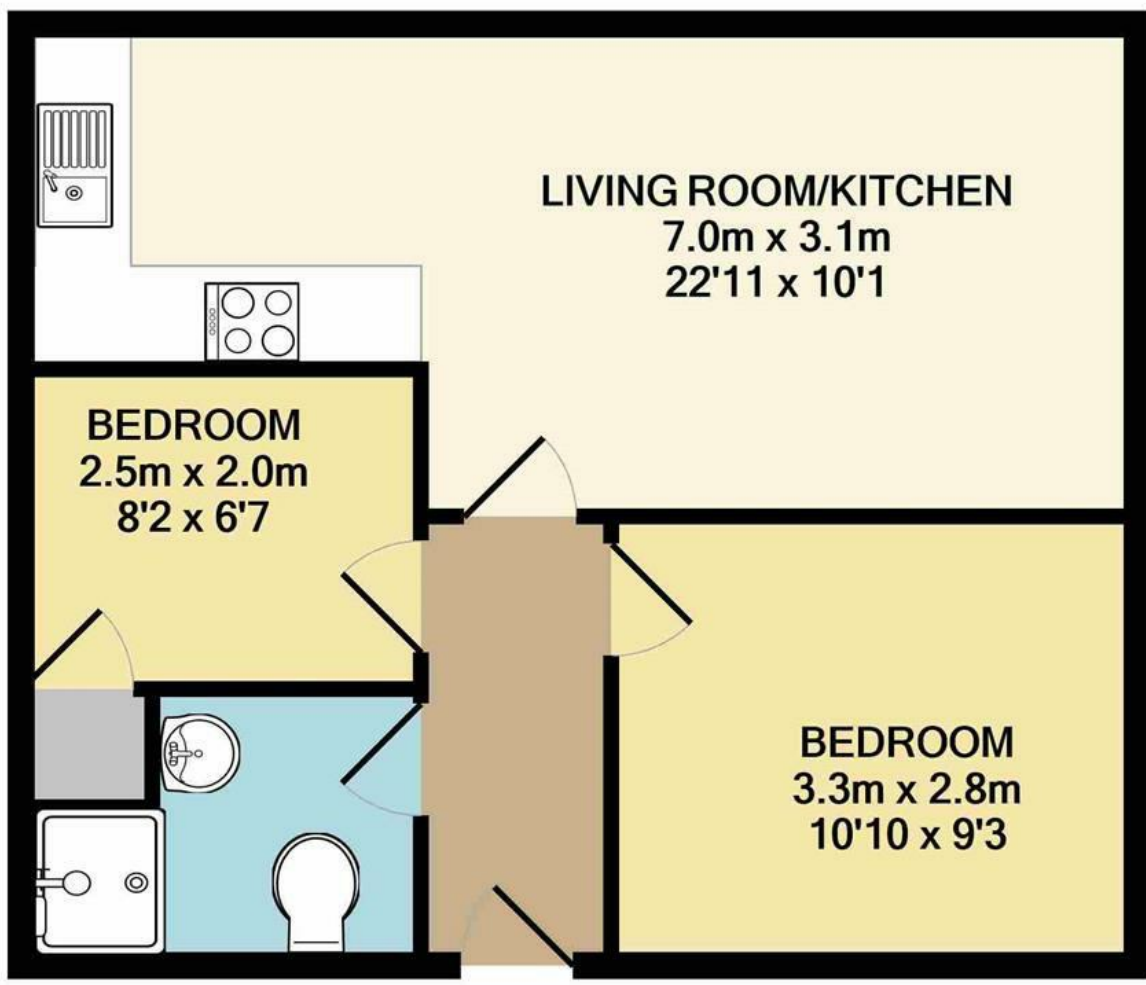

Surrey Street | Norwich | NR1
 Guide Price £170,000

abbotFox



Energy Efficiency Rating		
	Current	Potential
Very energy efficient - lower running costs		
(92 plus) A		
(81-91) B		
(69-80) C		
(55-68) D		
(39-54) E		
(21-38) F		
(1-20) G		
Not energy efficient - higher running costs		
England & Wales		EU Directive 2002/91/EC

Disclaimer – In accordance with the Property Misdescriptions Act, the company gives notice that all descriptions, references to condition, necessary permissions for use and other details are given in good faith and believed to be correct, but any intending lessees do not rely on them as statements of fact, but must satisfy themselves by inspection or other means, as to their accuracy.

TOTAL APPROX. FLOOR AREA 41.1 SQ.M. (443 SQ.FT.)

Whilst every attempt has been made to ensure the accuracy of the floor plan contained here, measurements of doors, windows, rooms and any other items are approximate and no responsibility is taken for any error, omission, or mis-statement. This plan is for illustrative purposes only and should be used as such by any prospective purchaser. The services, systems and appliances shown have not been tested and no guarantee as to their operability or efficiency can be given
 Made with Metropix ©2021



abbotFox presents this super stylish first floor two bedroom apartment within the popular Sentinel House development in Norwich's city centre.

Featuring two good sized bedrooms, a kitchen with integrated appliances, modern shower room and open plan living space.

The property is being sold with no onward chain and enjoys the benefits of a concierge service, residents' gym and residents' lounge.

